

Installing the ZX Board in the Ultra 1 Workstation

5 

This chapter describes how to install the ZX board in the SBus slot of an Ultra 1 or Ultra 1 Creator Series workstation.



Caution – When installing a ZX board in an Ultra 1 workstation, the workstation must not have either an internal 8mm tape drive or an internal DAT drive. These drives used in conjunction with the ZX board would exceed the system power capabilities.

Note – Use of the ZX board in an Ultra 1 workstation requires the Solaris 2.5.1 operating system, or a later version.

Note – The ZX board in an Ultra 1 workstation requires the “ZX Ultra 1 Kit,” part number 595-4072-01. This kit is not included with the ZX board installation kit and must be ordered separately. The kit can be ordered from Sun Sales/Telemarketing.

Installation Summary

Installation of the ZX board requires about 30 minutes. The following is an overview of the installation steps:

<i>Prepare the System for Installation</i>	<i>page 43</i>
<i>Attach the Antistatic Wrist Strap</i>	<i>page 44</i>
<i>Remove the Filler Plate</i>	<i>page 45</i>
<i>Install the ZX Board</i>	<i>page 46</i>
<i>Close the System Unit</i>	<i>page 50</i>
<i>Connect the Monitor</i>	<i>page 50</i>
<i>Power on the System</i>	<i>page 51</i>
<i>Reconfigure the System</i>	<i>page 52</i>

Prepare the System for Installation

Prepare the Ultra 1 system for installation of the ZX board as described in the installation guide that came with your system. Power down the system and remove the top cover as instructed in the installation guide.

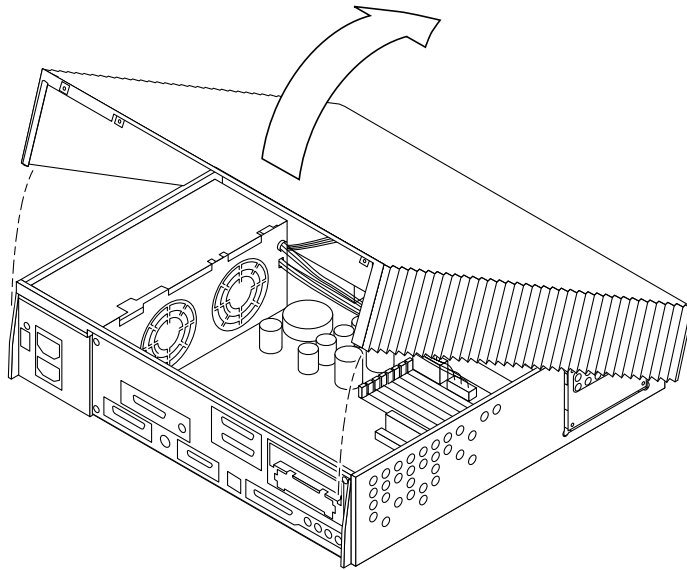

Figure 5-1 Removing Ultra 1 System Top Cover

Attach the Antistatic Wrist Strap

The antistatic wrist strap is provided with the installation kit. The wrist strap provides grounding for static electricity between your body and the system unit chassis. See Figure 5-2.



Caution – Boards, modules, and components can be damaged by harmful electrical charges if you do not wear a wrist strap.

To use a wrist strap:

- 1. Wrap the grounding strap with the conductive adhesive tape twice around your wrist.**
Make sure the adhesive side is against your skin.

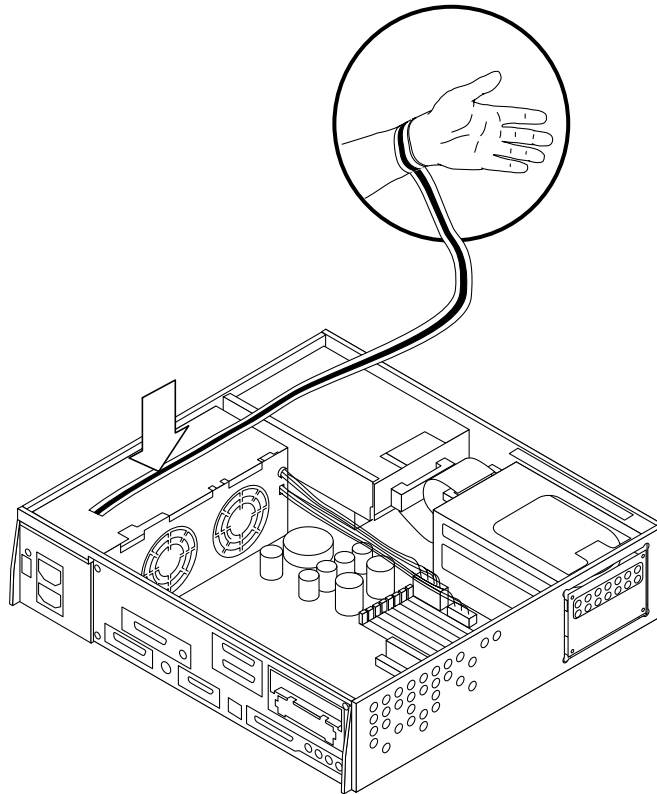

Figure 5-2 Attaching the Wrist Strap

2. **Attach the other end with the adhesive copper strip to the metal case of the power supply.**

Note - If you are moving the ZX board from an existing system to an Ultra system, the following step does not apply.

3. **Remove the ZX board from its antistatic envelope.**
Hold the board by the edges as shown in Figure 5-3.

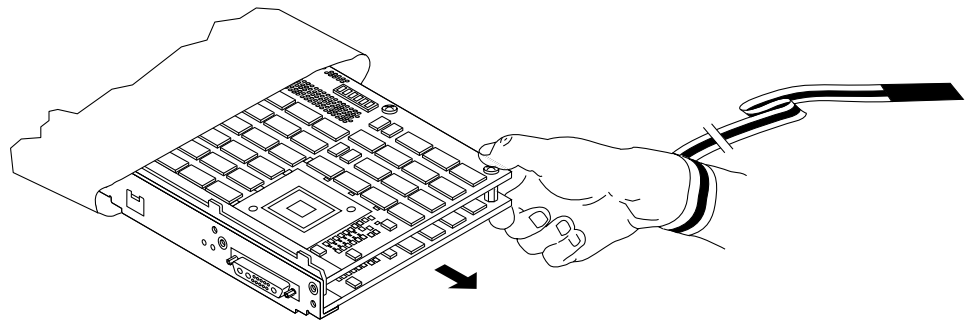

Figure 5-3 Removing the ZX Board from the Antistatic Envelope

Remove the Filler Plate

Remove the rear panel filler plate as described in the installation guide that came with your system.

Install the ZX Board

Install the ZX board into the workstation as follows:

- 1. Locate the SBus slots 0 and 1.**
See Figure 5-4.

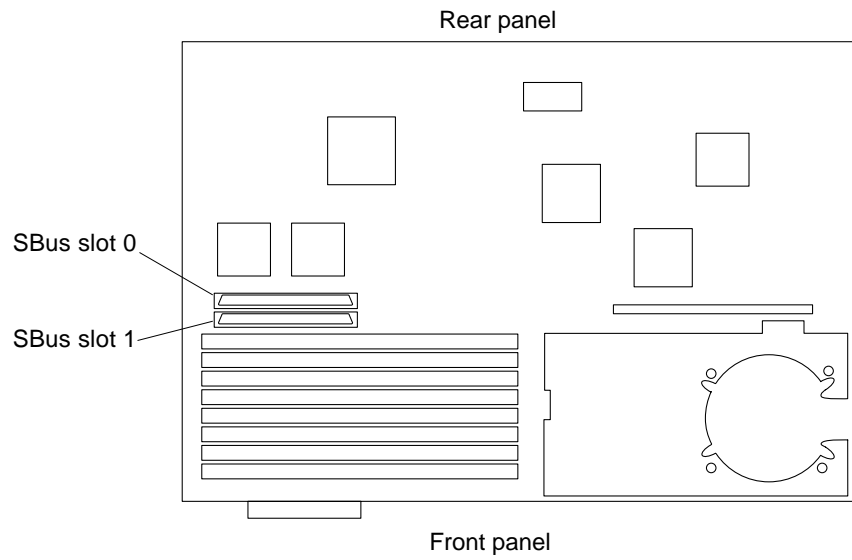

Figure 5-4 SBus Slots

2. Attach the male end of the ribbon cable to the SBus slot 0 connector.
See Figure 5-5.

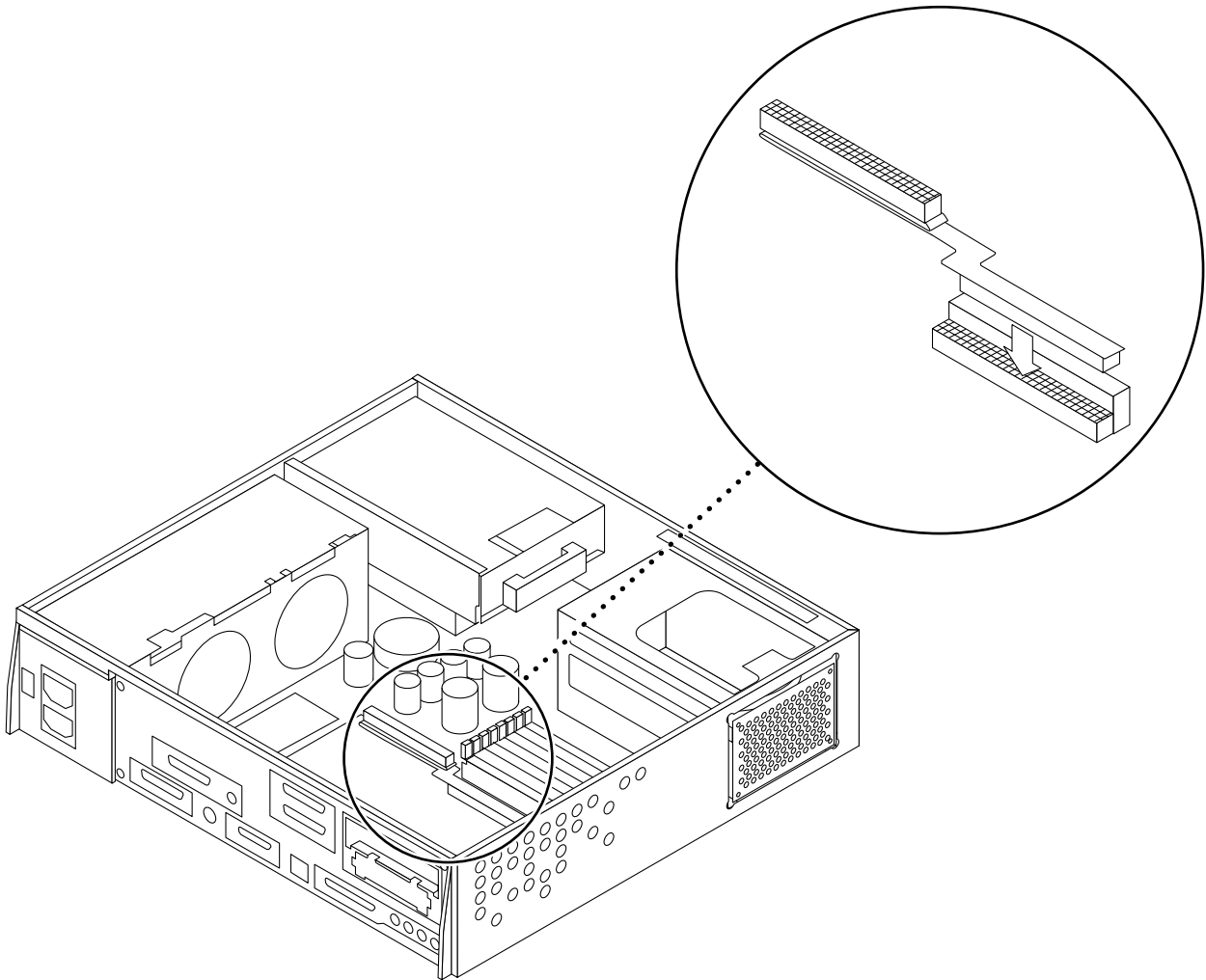

Figure 5-5 Connect Ribbon Cable to Workstation SBus Connector

- 3. Connect the female end of the ribbon cable to the ZX board.**
Make sure you connect the cable to the right-most ZX board connector as shown in Figure 5-6.

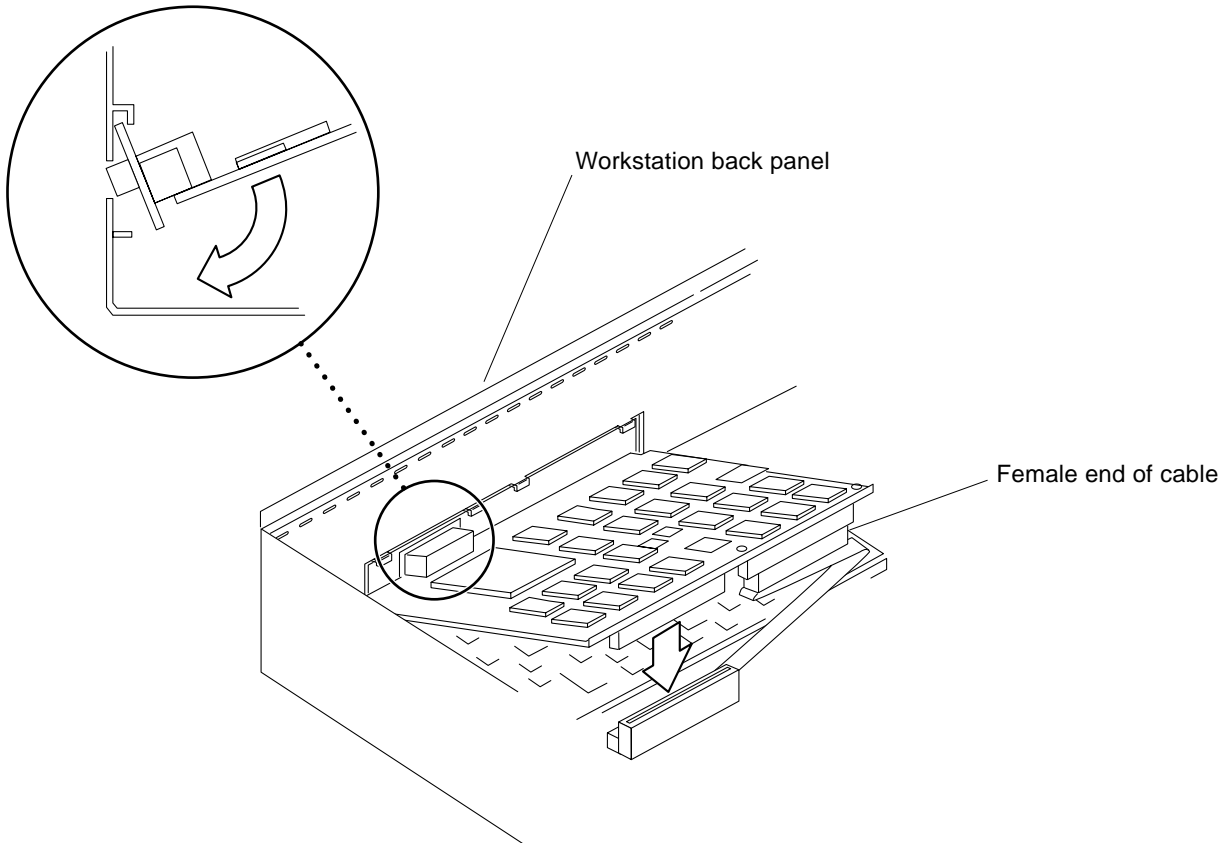

Figure 5-6 Connect Ribbon Cable to ZX Board Connector

- 4. Slide the board at an angle into the workstation back panel and align and engage the board backplate under the lip on the workstation back panel.**
See Figure 5-6.

- 5. Holding the ZX board in place against the back panel, align the ZX board's SBus connector with the corresponding SBus slot 1.**
See Figure 5-7.

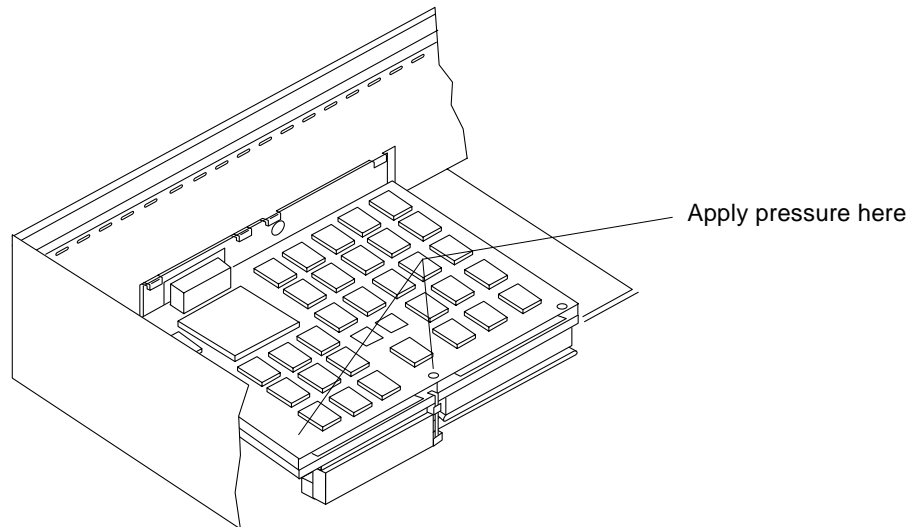

Figure 5-7 Align the ZX Board SBus Connector with SBus Slot 1

- 6. Gently press the board into the SBus slot.**
Apply pressure over the screws on the left side of the board to avoid bending the board.
- 7. Engage the two rear board retainers to fasten the board to the SBus slot.**

Close the System Unit

Remove the wrist strap from your wrist and the power supply. Close the system unit as described in the system installation guide.

Connect the Monitor

- 1. Remove the monitor from the packing container, if this is a new monitor.** Save the packaging material in case the monitor needs to be returned in the future.
- 2. Connect the monitor to the system unit video connector.** See Figure 5-8.

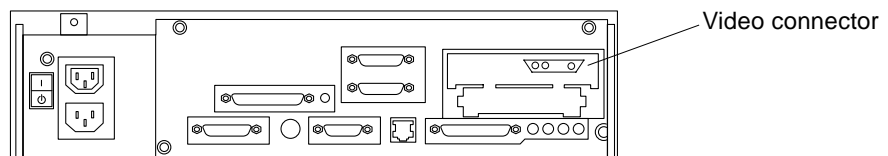

Figure 5-8 ZX Board Video Connector



Caution – The 13W3 D-shell monitor connector cable that came with your system has toroids for reduction of RFI. For regulatory compliance reasons, you must use this cable to connect the ZX to the monitor.

- 3. Connect the power cable to the electrical outlet.**

Power on the System



Warning – Before powering on the system unit, you must replace the cover and secure it. Failure to take this precaution may result in personal injury and system damage.

Turn the power on in this order:

1. Monitor
2. All peripherals
3. System Unit

Refer to the system installation guide for the power-on procedure if your system is part of a network.

Reconfigure the System

In Solaris 2.x, when an SBus board or peripheral device is added, the system does not recognize it automatically. You need to execute either the `touch /reconfigure` command before halting the system or `boot -r` command when the system is powered up after a device is added.

If the system did not recognize the normal halting procedure when you turned it off, you did not have the opportunity to execute the `touch /reconfigure` command. In that case, you need to execute the `boot -r` command, which does the same thing as the `touch /reconfigure` command.

The `boot -r` command is executed after interrupting the boot process. It is assumed that you have installed a new SBus board in the system and the system power is off.

Follow this procedure to execute the `boot -r` command.

1. Power up the system and wait about one minute.

The system starts to execute normal power up diagnostic and memory checking routines.

2. Abort the system by simultaneously pressing the Stop-a key or the Break key, as appropriate for your keyboard.

You will see the `ok` prompt.

3. Type `boot -r` and press Return.

A reconfiguration script is then executed. The system then boots.

If you experience any trouble with the system at this point, see Chapter 9, “Troubleshooting” on page 73.

What's Next

Configure the ZX Graphics Accelerator to work properly with your monitor, as described in Chapter 8, “Changing the Screen Resolution” on page 65.

Note – If you plan to use the ZX stereo connector, see the information on page 84.
